

CHANGE TABLE

CHANGE	LENGTH	BEARING	CHORD DIST.	BEARING	AREA
C1	16.43	80.00	41.73	S02°24'21"E	582.90
C2	19.02	61.00	47.74	N79°31'28"W	187.72
C3	19.72	157.00	48.82	S82°20'12"E	337.48
C4	664.72	878.04	676.74	S53°29'36"E	452,002
C5	458.81	508.58	441.49	N58°48'36"W	51,400.07
C6	374.83	333.00	297.19	N07°28'27"W	47,001.17
C7	183.58	238.88	158.39	N02°01'18"E	9,000.05
C8	301.08	558.18	297.23	N58°29'56"W	31,211.47
C9	280.29	413.43	134.82	S48°57'07"E	38,024.18
C10	429.47	340.00	248.72	S01°48'14"W	72,242.20
C11	118.50	610.00	411.26	S13°31'20"E	39,743.10
C12	122.71	788.04	61.46	S53°29'36"E	8,582.31

LINE TABLE

LINE	BEARING	LENGTH
L1	S17°25'34"E	103.52
L2	N38°55'07"W	13.20
L3	S88°40'24"W	70.00
L4	S81°18'38"E	78.00
L5	S12°00'56"E	27.54
L6	N22°00'41"E	60.00
L7	N42°00'41"E	47.50
L8	N31°19'38"W	106.57
L9	S42°13'21"W	60.00
L10	S58°11'50"W	60.00

DRAINAGE AND UTILITY EXPENDS

In addition to the easements depicted on this plat, the owner shall be responsible for the installation and maintenance of utility lines and/or appurtenances. These drainage and utility easements are more specifically defined below:

- 10 feet along all lot lines which define a road right-of-way
- 10 feet along each side of all lot lines.

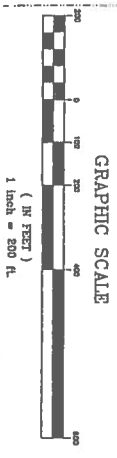
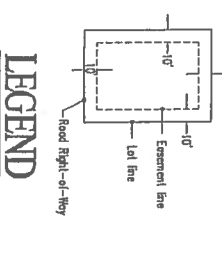

As shown in Colorado law, you must commence your legal action within the period specified in this notice. If you do not commence your legal action within the period specified, you will be deemed to have accepted the terms of this plat. The plat is subject to the provisions of the Colorado Plat Act.

SCHEMESER GORDON MEYER INC.
 SURVEYORS
 ENGINEERS
 118 W. 8th Street, Suite 200
 Greenwood Springs, Colorado 81601
 (970) 945-1004 FAX (970) 945-5949
 Aspen, Colorado (970) 925-6727

SKYLAND - THIRD FILING

DATE	BY	REVISION

FINAL PLAT

Job No. 921851-01
 Drawn by: RAV
 Date: March 2000
 Appr. by: SE

2 OF 7

2 of 7 N 78.98 D 6.98 N 6.98 Summit County